

CF/CFU cylinders supplied by VASI are all constructed of high quality steel and are designed for harsh environments. These units are meeting customer requirements across the globe.

The cylinders are sturdily built for difficult applications and are used in e.g. the marine and mining industries, among many others. Mounting accessories are available for the base and rod end of these cylinders. Also, the CF cylinders can easily be mounted in applications by the use of its collar mounting threads.

- 5-45 ton capacity and 127-300 mm stroke length.
- High strength alloy steel design for multi purpose use.
- Removable grooved piston cap and chromated piston rods.
- **CF** = Single acting push cylinders with spring return
- **CFU** = Single acting push cylinders with spring return and extended piston pin



Name	Item code	Working press. MPa	Capacity kN (t)	Stroke mm	Stroke volume cm <sup>3</sup>	Diameter mm	Height mm	Weight kg
CF104B	27485	70	49 (5)	127	90	37.5	267	1.7
CF204B	27486	70	49 (5)	200	142	37.5	340	2.4
CF110C	43829	70	111 (11)	150	239	56.5	321	4.7
CF210C	43830	70	111 (11)	200	318	56.5	372	5.5
CF310C	43831	70	111 (11)	300	477	56.5	474	7.0
CF120A	24178	70	232 (24)	127	422	84	337	10.2
CF220A	24973	70	232 (24)	200	664	84	410	12.4
CF320A	24974	70	232 (24)	300	996	84	510	16.0
CFU2010C	43837	70	111 (11)	200	318	56.5	387	5.3
CFU2510C	43838	70	111 (11)	250	398	56.5	437	6.0

# Single acting push cylinders CF/CFU

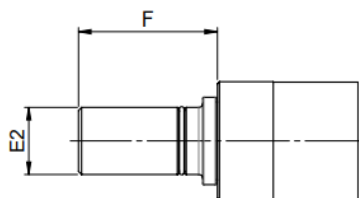

CFU2010C - CFU2510C

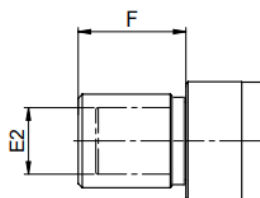

CF110 - CF310  
CF110BL - CF310BL

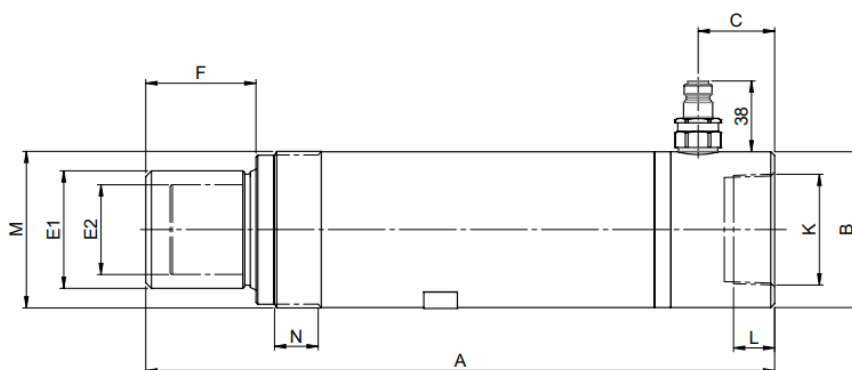

CF120 - CF320  
CF120BL - CF320BL

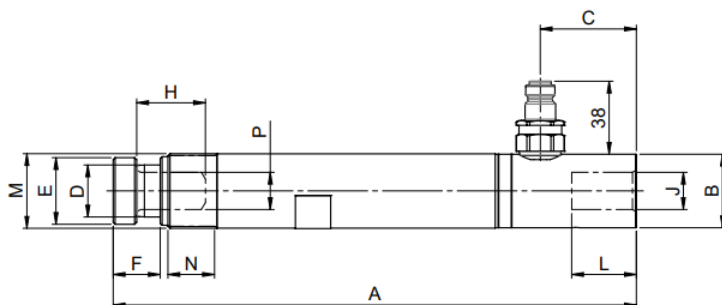

CF104 - CF204  
CF104BL - CF204BL

Modell	Artikelnummer / Part number	Max arbetstryck / Max working pressure MPa	Kapacitet/ capacity kN	Slaglängd/ stroke mm	Kolvareal/ piston area cm <sup>2</sup>	Slagvolym/ stroke volume cm <sup>3</sup>	A mm	B Ø mm	C mm	D Ø mm	E1 Ø mm	E2 Ø mm	F mm	H mm	J mm	K	L mm	M	N mm	P Ø mm	Vikt/ weight kg
CF104B	27485	70	49	127	7,1	90	267	37,5	49	26,5	34	---	25	33	19	---	33	1 1/2" -16 UN	25	19	1,7
CF204B	27486	70	49	200	7,1	142	340	37,5	49	26,5	34	---	25	33	19	---	33	1 1/2" -16 UN	25	19	2,4
CF110C	43829	70	111	150	15,9	239	321	56,5	43	38	45	32,25	52,5	---	---	1 1/4" -11 1/2 NPT	22	2 1/4" -14 UN	27	---	4,7
CF210C	43830	70	111	200	15,9	318	372	56,5	43	38	45	32,25	52,5	---	---	1 1/4" -11 1/2 NPT	22	2 1/4" -14 UN	27	---	5,5
CF310C	43831	70	111	300	15,9	477	474	56,5	43	38	45	32,25	52,5	---	---	1 1/4" -11 1/2 NPT	22	2 1/4" -14 UN	27	---	7
CF120A	24178	70	232	127	33,2	422	337	84	41	60	63	48	59	---	---	2" -11 1/2 NPT	22	3 5/16" -12 UN	25	---	10,2
CF220A	24973	70	232	200	33,2	664	410	84	41	60	63	48	59	---	---	2" -11 1/2 NPT	22	3 5/16" -12 UN	25	---	12,4
CF320A	24974	70	232	300	33,2	996	510	84	41	60	63	48	59	---	---	2" -11 1/2 NPT	22	3 5/16" -12 UN	25	---	16
CFU2010C	43837	70	111	200	15,9	318	387	56,5	43	38	---	32,25	67	---	---	1 1/4" -11 1/2 NPT	22	2 1/4" -14 UN	27	---	5,3
CFU2510C	43838	70	111	250	15,9	398	437	56,5	43	38	---	32,25	67	---	---	1 1/4" -11 1/2 NPT	22	2 1/4" -14 UN	27	---	6